

Stage 1- Rifle Pistol

GUN READY CONDITION: Rifle loaded to Division capacity, starting at low ready at fault line. Pistol – magazine inserted, chamber empty.

TARGETS: 4 rifle steel, 2 pistol plate racks
SCORED HITS: called hits on rifle, plates down on pistol
RULE: Latest 3 Gun Nation
NOTE: Pistol may be chambered at first pistol V-Tac
PAR TIME: 120 seconds **WALK THRU:** 5 minutes
SHOTS REQUIRED: 16 rifle and 12 pistol

STAGE PROCEDURE: Shoot all 4 rifle steel from each of 4 V-Tacs using only ports that are marked RED. Ground rifle and move to pistol V-Tacs and engage 1 plate rack each thru ports marked in green.



Rifle Targets

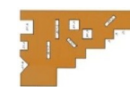

Pistol targets



Pistol loading
line

Rifle V tacs

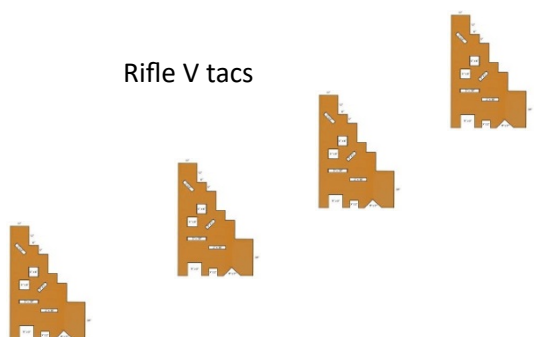

Rifle Dump
barrel

